

Submersible Non-clog Pump

Model DLFU
Model DVFU
Model DDLFU



water | wastewater



Model DLFU DVFU DDLFU

Features

- **Watertight cable entry system** prevents capillary action and protects against moisture; reduces maintenance costs
- **Heavy duty, high efficiency, air filled, Class F insulated, rated for 311°F with a 1.15 service factor** dissipates heat easily; thermal protection in each phase of windings protects; operates cooler with higher efficiencies; longer service life with lower operating costs
- **Self cooling jacket** eliminates the need for external pumping devices or special heat transfer fluids; offers simplicity and high reliability by effectively dissipating heat in dry pit applications only
- **Single and double row thrust bearings** carries thrust loads with L-10 life of 60,000 hours; ensures long, dependable operation and lowers maintenance costs
- **Mechanically actuated float switch** provides early warning of mechanical seal failure; avoids costly motor repairs
- **Double mechanical seals — silicon carbide lower seals, carbon/ceramic upper** - hard faced upper and lower seals operate in an oil bath; providing longer service life and lower maintenance costs
- **High efficiency impellers** pass large solids with high outputs and reduces power consumption; impellers are optimized for hydraulic coverage; lowers operating costs
- **Replaceable wear components** maintains working clearances while reducing casing and volute costs

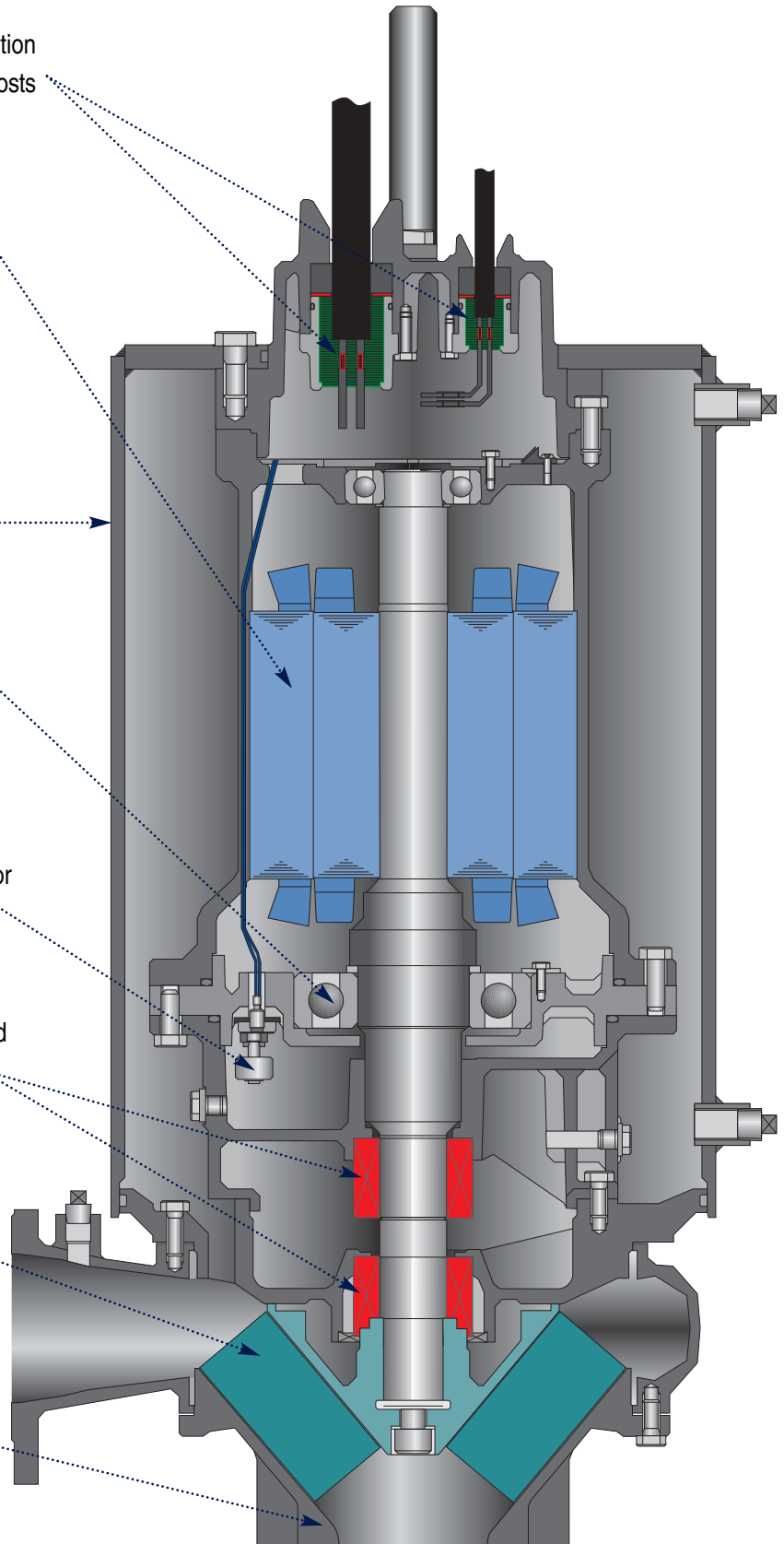

Submersible Non-Clog Pump

Model DLFU arrangement options

Model DDLFU Dry Pit design

Motor cooling is provided by internal recirculation of pumpage through water jacket

Mechanical seal oil chamber

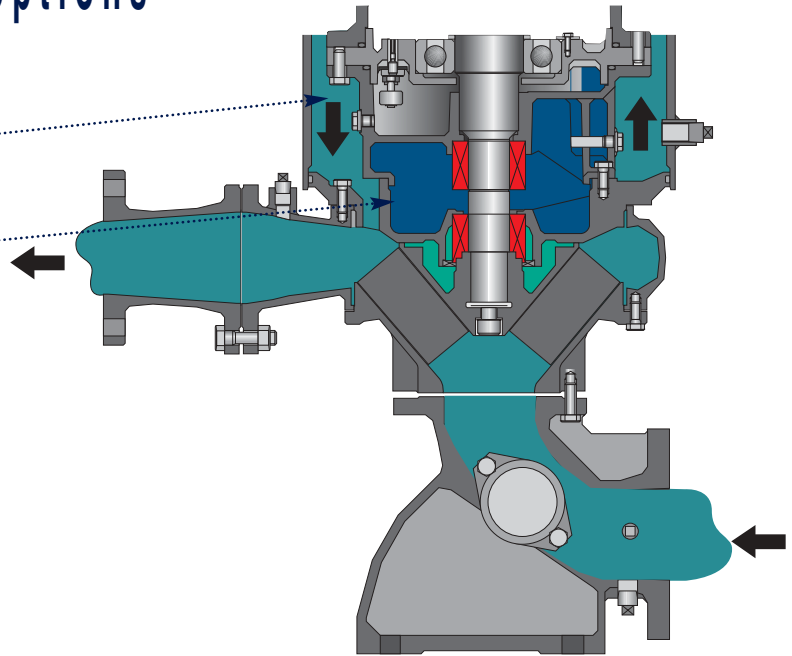

Model DVFU Vortex design

Vortex design is ideal for handling stringy materials without clogging

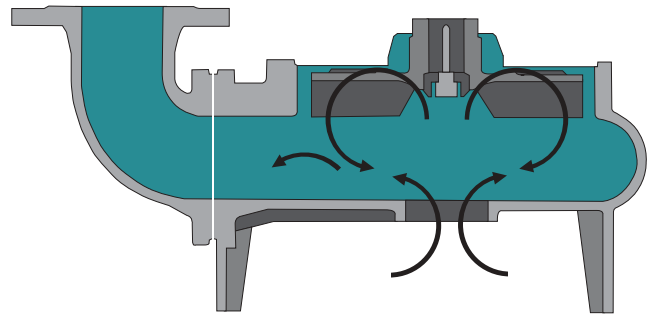

Cable entry system

- **Primary seal** — grommet (NBR)
- **Secondary sealing** — O rings (NBR)
- **Epoxy resin** — prevents capillary action
- **Cable gland** (grey cast iron)
- **Solid joint butt connector** (copper)

Note: Entry system is the same for both power and control cables.

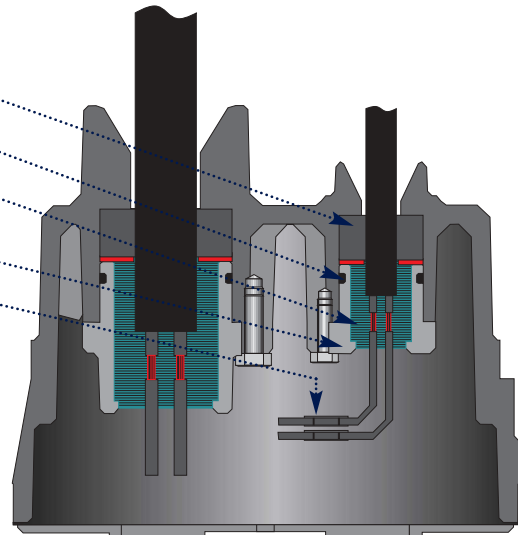

Model DLFU DVFU DDLFU

Materials

QDC & Slide Rail System

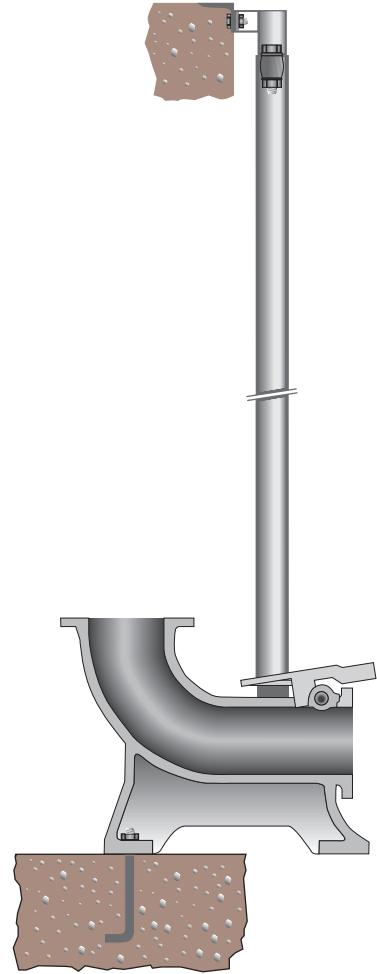
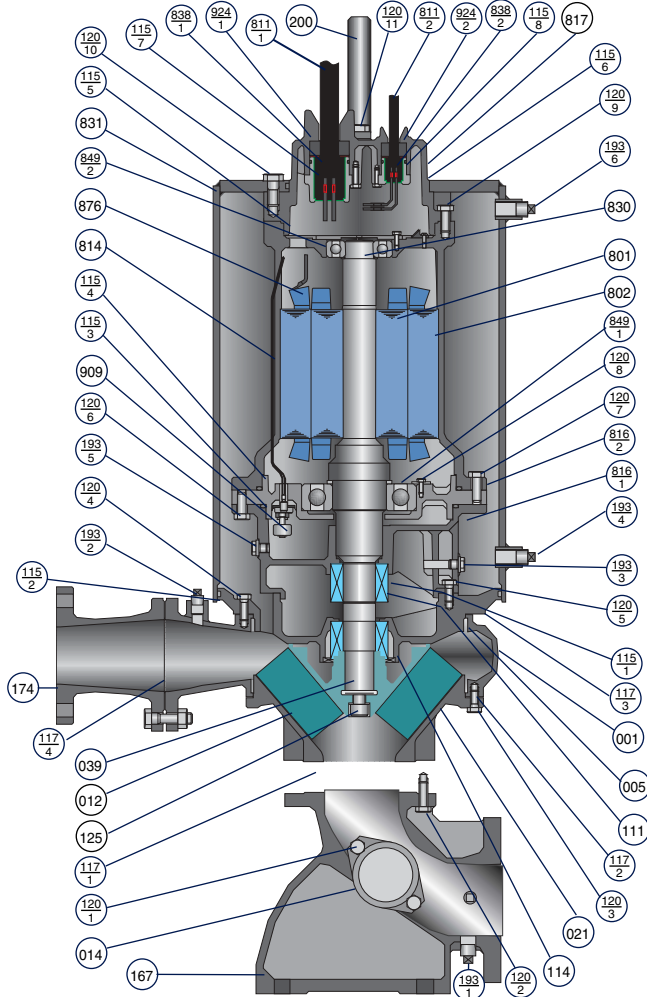

No.	Qty	Part Name	Material	ATM/AISI Code	No.	Qty	Part Name	Material	ATM/AISI Code
001	1	Casing	Cast Iron	A48 Class 30	120-11	2	Bolt	304 Stainless	AISI304
005	1	Intermediate Casing	Cast Iron	A48 Class 30	125	1	Bolt	304 Stainless	AISI304
012	1	Suction Cover	Cast Iron	A48 Class 30	167	1	Suction Elbow	Cast Iron	A48 Class 30
014	1	Hand Hole Cover	Cast Iron	A48 Class 30	174	1	Discharge Pipe	Cast Iron	A48 Class 30
021	1	Impeller	Cast Iron	A48 Class 30	193-1	1	Plug	Steel	
039	1	Key	420 Stainless	AISI420	193-2	1	Plug	304 Stainless	AISI304
111	1 set	Mechanical Seal	—		193-3	1	Plug	304 Stainless	AISI304
114	1	Oil Seal	Rubber (NBR)		193-4	1	Plug	304 Stainless	AISI304
115-1	1	O-ring	Rubber (NBR)		193-5	1	Plug	304 Stainless	AISI304
115-2	1	O-ring	Rubber (NBR)		193-6	1	Plug	304 Stainless	AISI304
115-3	1	O-ring	Rubber (NBR)		200	1	Lifting Hanger	Steel	A283 Grade D
115-4	1	O-ring	Rubber (NBR)		801	1	Rotor	—	
115-5	1	O-ring	Rubber (NBR)		802	1	Stator	—	
115-6	1	O-ring	Rubber (NBR)		811-1	1	Power Cable	—	
115-7	1	O-ring	Rubber (NBR)		811-2	1	Control Cable	—	
115-8	1	O-ring	Rubber (NBR)		814	1	Motor Cover	Cast Iron	A48 Class 30
117-1	1	Gasket			816-1	1	Bracket	Cast Iron	A48 Class 30
117-2	1	Gasket			816-2	1	Bracket	Cast Iron	A48 Class 30
117-3	1	Gasket			817	1	Bracket	Cast Iron	A48 Class 30
117-4	1	Gasket			830	1	Shaft	403 Stainless	AISI403
120-1	2	Bolt	304 Stainless	AISI304	831	1	Water Jacket	Steel	A283 Grade D
120-2	8½	Bolt	304 Stainless	AISI304	838-1	1	Washer	304 Stainless	AISI304
120-3	8	Bolt	304 Stainless	AISI304	838-2	1	Washer	304 Stainless	AISI304
120-4	8	Bolt	304 Stainless	AISI304	849-1	1	Ball Bearing	—	
120-5	4	Bolt	304 Stainless	AISI304	849-2	1	Ball Bearing	—	
120-6	6	Bolt	304 Stainless	AISI304	876	3	Motor Protector	—	
120-7	6	Bolt	304 Stainless	AISI304	909	1	Leakage Detector	—	
120-8	3	Bolt	304 Stainless	AISI304	924-1	1	Packing	Rubber (NBR)	
120-9	6	Bolt	304 Stainless	AISI304	924-2	1	Packing	Rubber (NBR)	
120-10	6	Bolt	304 Stainless	AISI304					

- †: Recommended spare parts.
- Quick Discharge Disconnect applies to Wet Pit installations only.
- Cooling jacket is used on dry pit configurations

Submersible Non-Clog Pump

Specifications

- DLFU & DDLFU capacities to 4100 GPM heads to 243 feet
- DVFU capacities to 1000 GPM heads to 120 feet
- Horsepower range to 60 HP
- 1800 RPM
- Submergence to 65 feet
- Liquid sump temperatures to 104°F
- Spherical solids to 5"
- Stainless steel shaft
- 1.15 motor service factor
- 20 starts per hour
- L-10 bearing life of 60,000 hours
- Seal leak detection system
- Motor over temperature protection embedded in windings
- FM explosion proof, Class 1, Division 1, Group C, D available

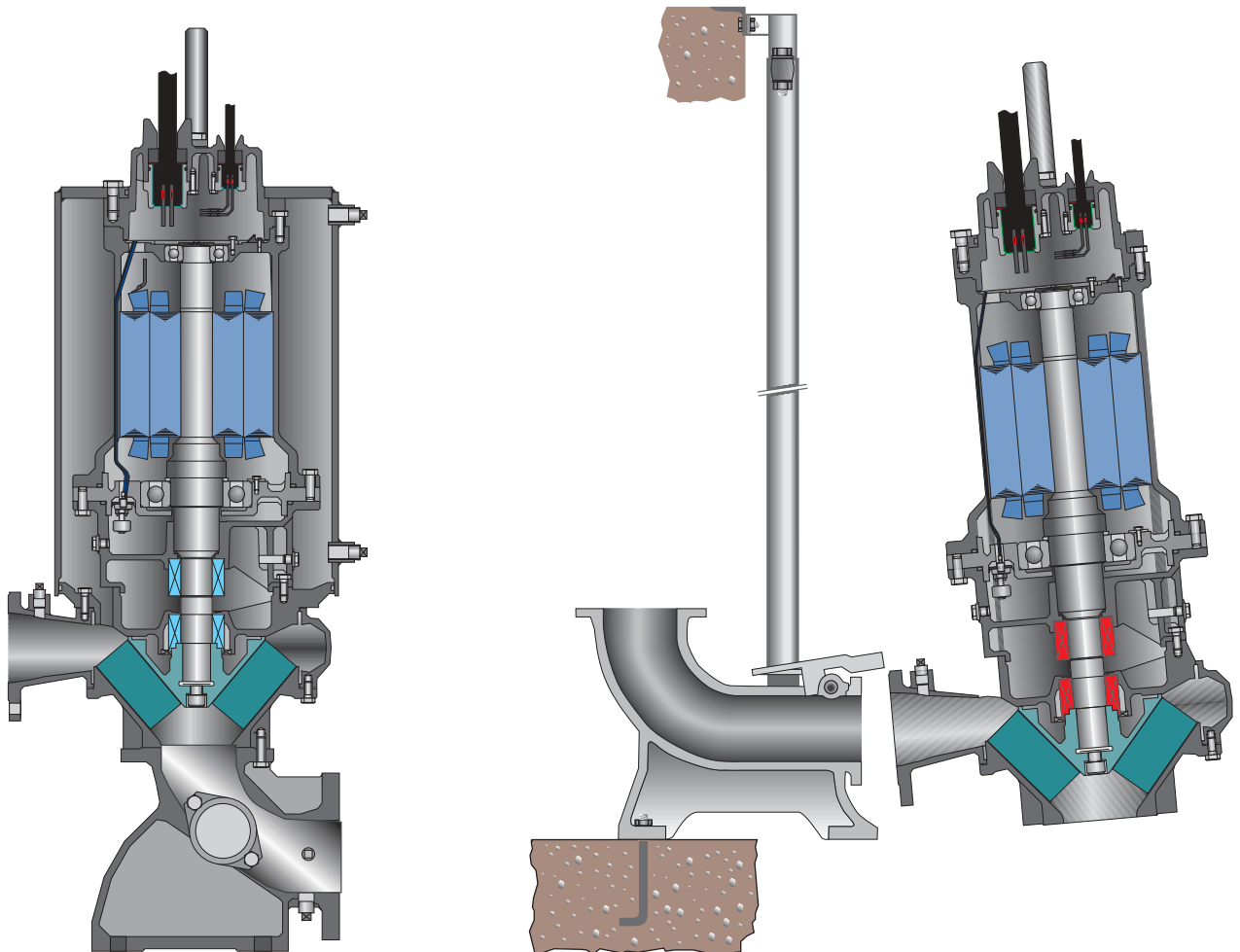

Model DLFU

Selection chart

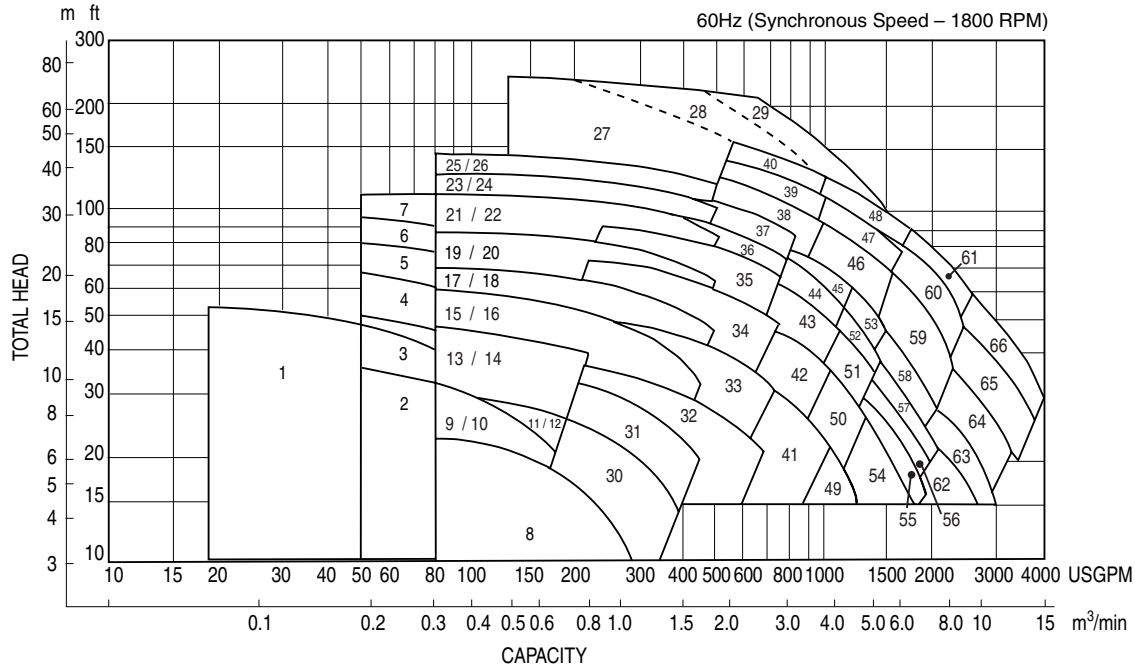

Please note: Overlap in coverage is designated by the two numbers; for example "9 / 10". Refer to the legend below for the specific model numbers.

1	50DLFU61.5 2HP	19	80DLFU611 15HP	37	100DLFU622 30HP	55	250DLBFU615 20HP
2	80DLMFU61.5 2HP	20	100DLMFU611 15HP	38	150DLFU630 40HP	56	250DLCFU615 20HP
3	80DLMFU62.2 3HP	21	80DLFU615 20HP	39	150DLFU637 50HP	57	250DLFU618 25HP
4	80DLMFU63.7 5HP	22	100DLMFU615 20HP	40	150DLFU645 60HP	58	250DLFU622 30HP
5	80DLMFU65.5 7½HP	23	80DLFU618 25HP	41	150DLFU67.5 10HP	59	250DLFU630 40HP
6	80DLCMFU67.5 10HP	24	100DLMFU618 25HP	42	150DLFU611 15HP	60	250DLFU637 50HP
7	80DLCMFU611 15HP	25	80DLFU622 30HP	43	150DLFU615 20HP	61	250DLFU645 60HP
8	100DLFU61.5 2HP	26	100DLMFU622 30HP	44	150DLFU618 25HP	62	300DLFU618 25HP
9	80DLFU61.5 2HP	27	100DLFU630 40HP	45	150DLFU622 30HP	63	300DLFU622 30HP
10	100DLMFU61.5 2HP	28	100DLFU637 50HP	46	200DLFU630 40HP	64	300DLFU630 40HP
11	80DLFU62.2 3HP	29	100DLFU645 60HP	47	200DLFU637 50HP	65	300DLFU637 50HP
12	100DLMFU62.2 3HP	30	100DLFU62.2 3HP	48	200DLFU645 60HP	66	300DLFU645 60HP
13	80DLFU63.7 5HP	31	100DLFU63.7 5HP	49	200DLFU67.5 10HP		
14	100DLMFU63.7 5HP	32	100DLFU65.5 7½HP	50	200DLFU611 15HP		
15	80DLFU65.5 7½HP	33	100DLFU67.5 10HP	51	200DLFU615 20HP		
16	100DLMFU65.5 7½HP	34	100DLFU611 15HP	52	200DLFU618 25HP		
17	80DLFU67.5 10HP	35	100DLFU615 20HP	53	200DLFU622 30HP		
18	100DLMFU67.5 10HP	36	100DLFU618 25HP	54	250DLFU611 15HP		



EBARA International Corporation

Standard Pump Division

1651 Cedar Line Drive • Rock Hill, SC 29730 • (t) 803 327 5005 • (f) 803 327 5097 • info@pumpsebara.com • www.pumpsebara.com

© 2000 EBARA International Corporation

EICDLFU 0503